

FEATURES

- ◆ 8-Shelves tall for maximum New Release perimeter merchandising.
- ◆ Each shelf is 5" deep for video back-stock or spine-out.
- ◆ Available in 3ft and 4ft length, white or almond.
- ◆ Add colored end panels, headers, or toe kicks for store branding.
- ◆ Fixtures ship knocked-down for freight savings. A 6,000 sq. ft. store ships in just one truckload. Easy to assemble.
- ◆ Add finished backs when visible at store windows & kids areas.
- ◆ Easily create modular adult rooms with just Tall Wall Fixtures. No construction

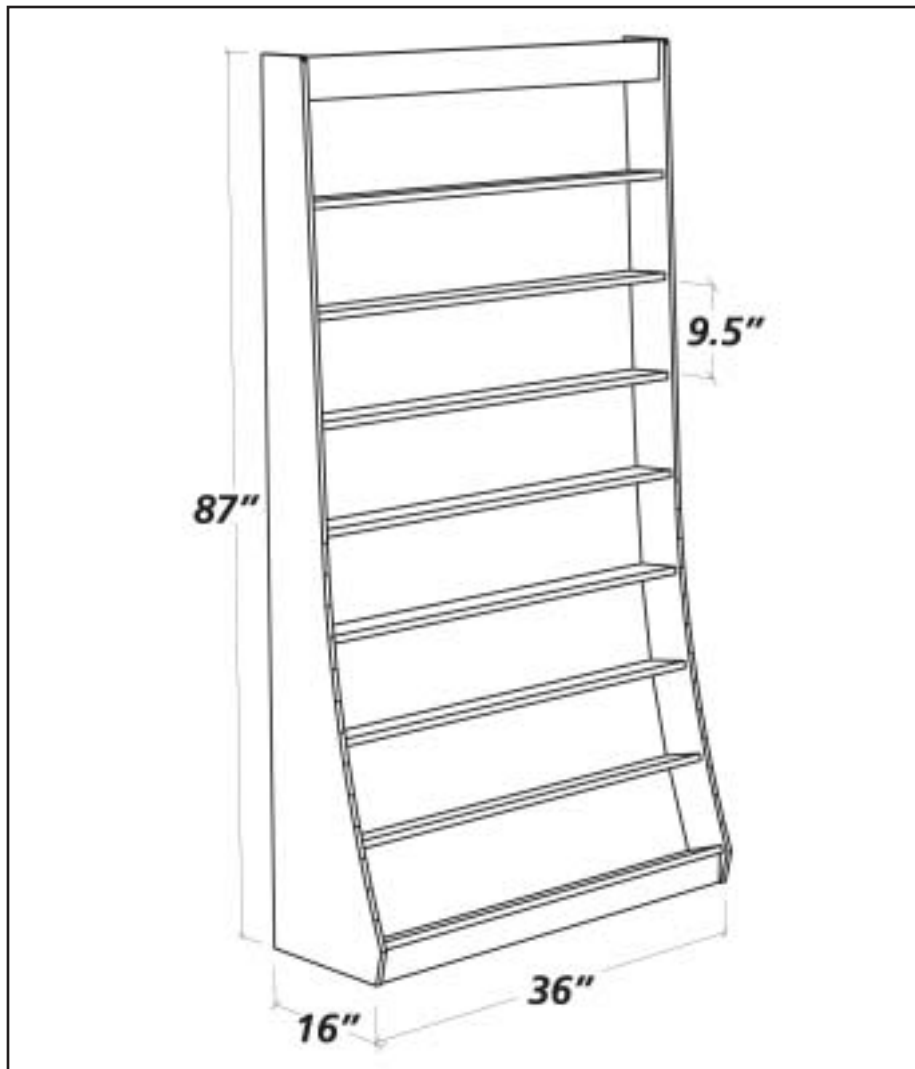

FEATURES

- ◆ 8-Shelves tall for maximum New Release perimeter merchandising.
- ◆ Each shelf is 5" deep for video back-stock or spine-out.
- ◆ Available in 3ft and 4ft length, white or almond.
- ◆ Add colored end panels, headers, or toe kicks for store branding.
- ◆ Fixtures ship knocked-down for freight savings. A 6,000 sq. ft. store ships in just one truckload. Easy to assemble.
- ◆ Add finished backs when visible at store windows & kids areas.
- ◆ Easily create modular adult rooms with just Tall Wall Fixtures. No construction



FEATURES

- ◆ 5-Shelves tall for Low Wall merchandising in front of windows
- ◆ Create “kids areas”.
- ◆ Each shelf is 5” deep for video back-stock or spine-out.
- ◆ Available in white or almond.
- ◆ Add colored end panels, headers, or toe kicks for store branding.
- ◆ Fixtures ship knocked-down for freight savings. A 6,000 sq. ft. store ships in just one truckload. Easy to assemble.
- ◆ Add finished backs when visible at store windows & kids areas.



FEATURES

- ◆ 5-Shelves tall for Low Wall merchandising in front of windows
- ◆ Create “kids areas”.
- ◆ Each shelf is 5” deep for video back-stock or spine-out.
- ◆ Available in white or almond.
- ◆ Add colored end panels, headers, or toe kicks for store branding.
- ◆ Fixtures ship knocked-down for freight savings. A 6,000 sq. ft. store ships in just one truckload. Easy to assemble.
- ◆ Add finished backs when visible at store windows & kids areas.

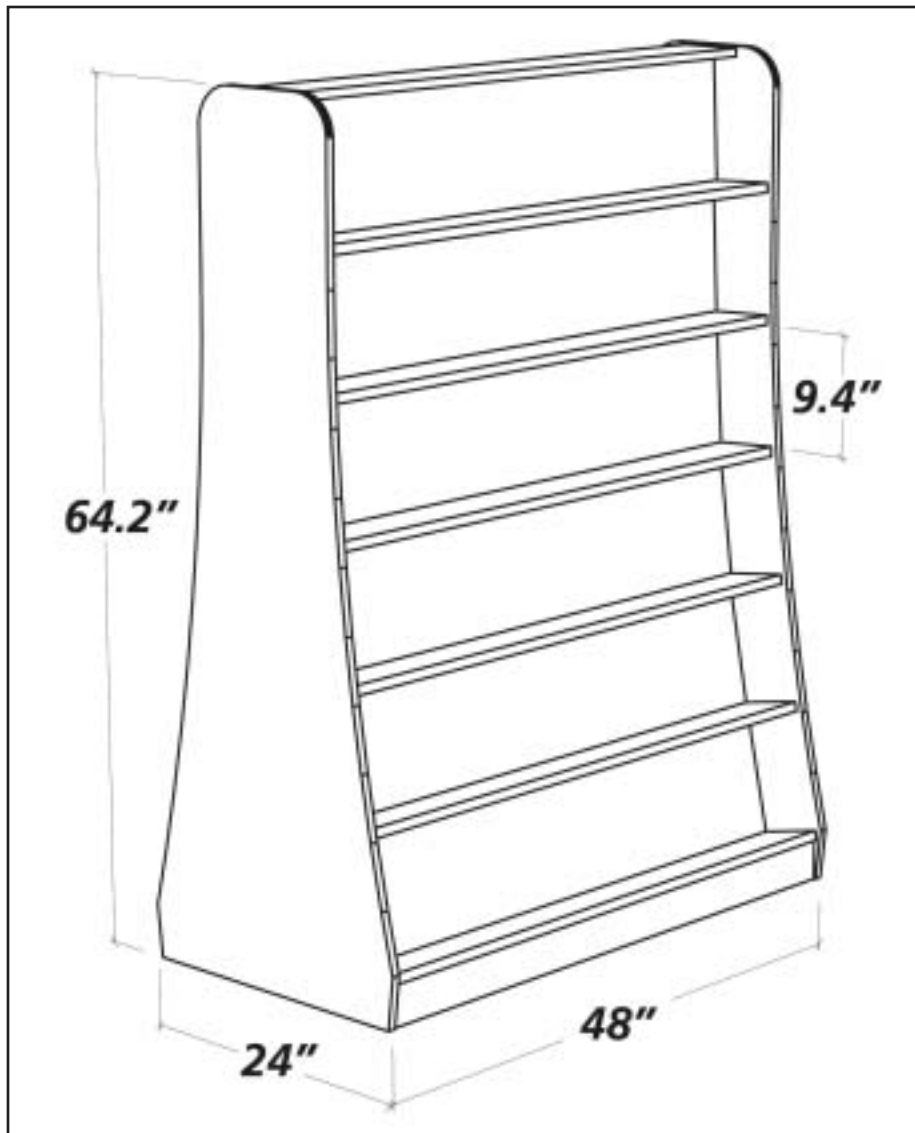

FEATURES

- ◆ 12-Shelf Aisles for maximum center store merchandising.
- ◆ Each shelf is 5" deep for video back-stock or spine-out.
- ◆ Available in white or almond.
- ◆ Add colored end panels, headers, or toe kicks for store branding.
- ◆ Add Slatwall End Panels for merchandising.
- ◆ Fixtures ship knocked-down for freight savings. A 6,000 sq. ft. store ships in just one truckload. Easy to assemble.

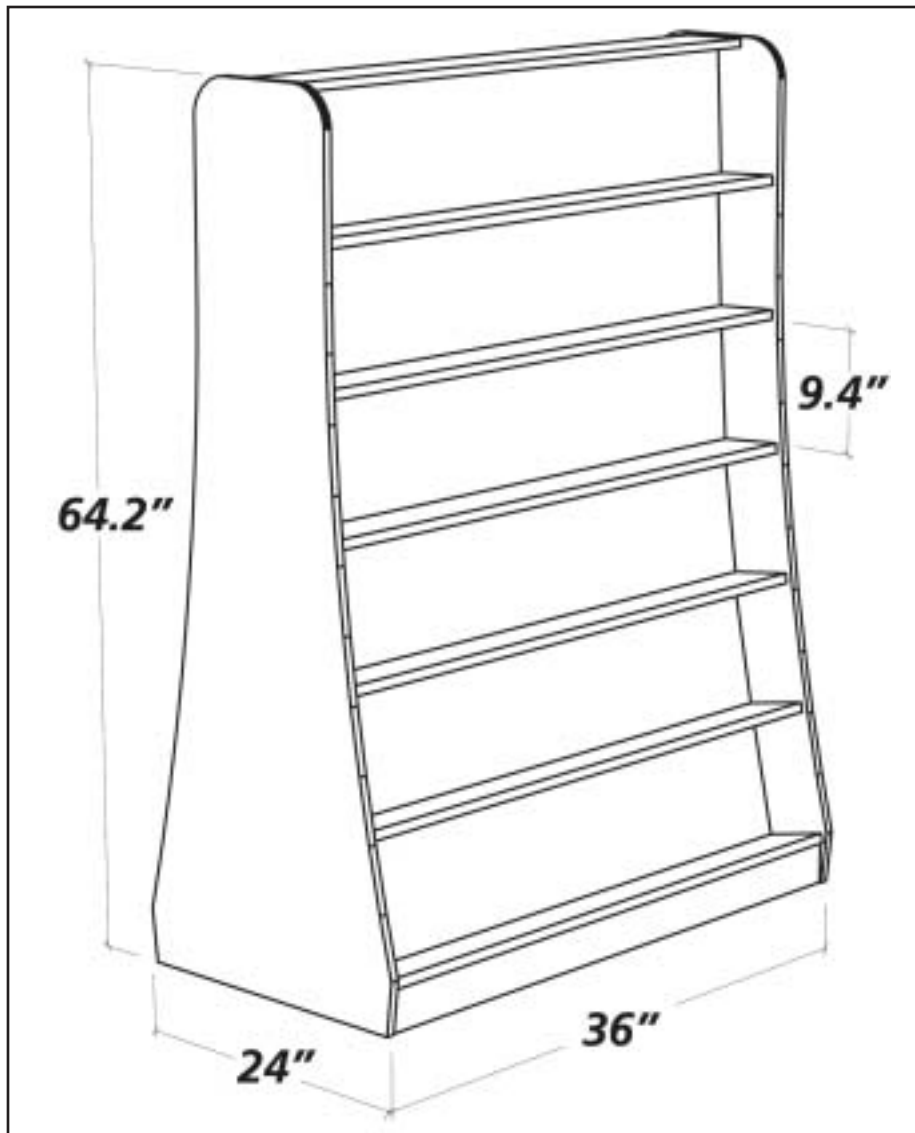

FEATURES

- ◆ 12-Shelf Aisles for maximum center store merchandising.
- ◆ Each shelf is 5" deep for video back-stock or spine-out.
- ◆ Available in white or almond.
- ◆ Add colored end panels, headers, or toe kicks for store branding.
- ◆ Add Slatwall End Panels for merchandising.
- ◆ Fixtures ship knocked-down for freight savings. A 6,000 sq. ft. store ships in just one truckload. Easy to assemble.

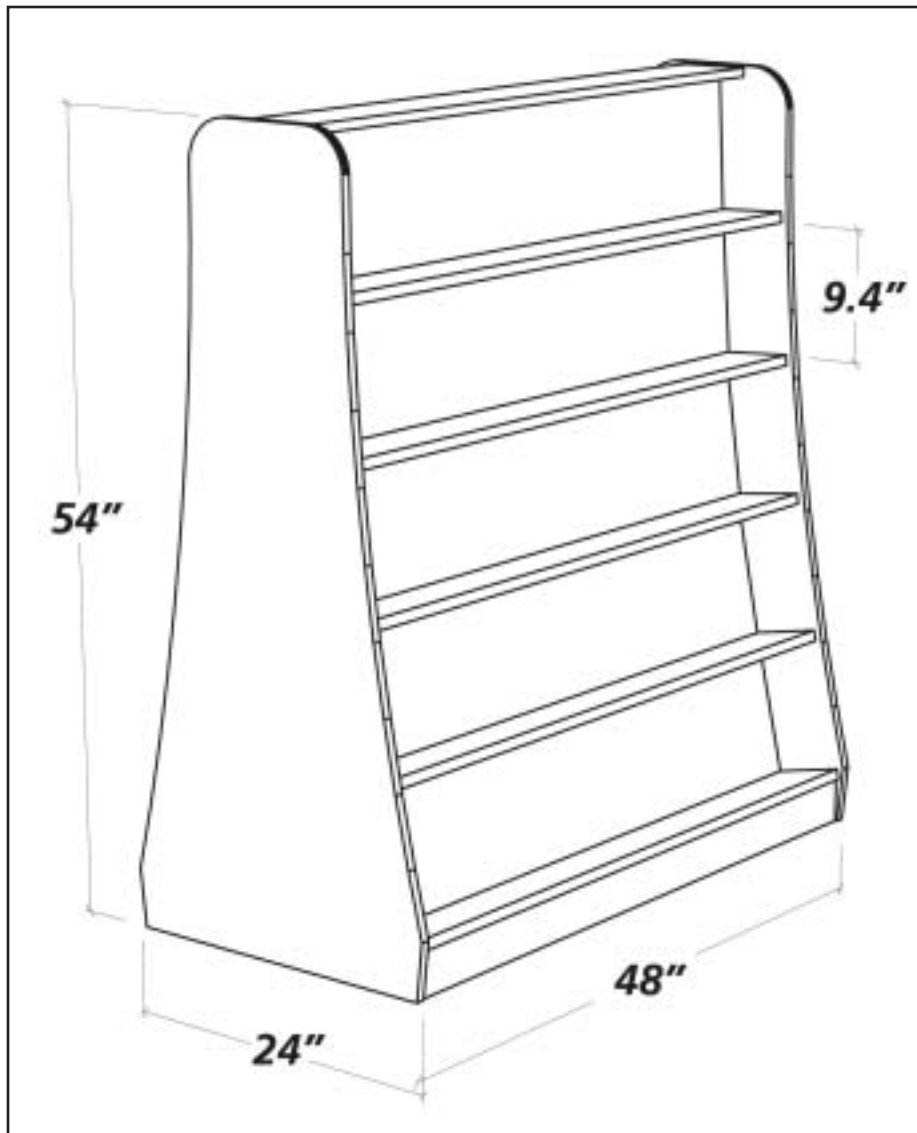

FEATURES

- ◆ 10-Shelf Aisles for maximum center store merchandising.
- ◆ Each shelf is 5" deep for video back-stock or spine-out.
- ◆ Available in white or almond.
- ◆ Add colored end panels, headers, or toe kicks for store branding.
- ◆ Add Slatwall End Panels for merchandising.
- ◆ Fixtures ship knocked-down for freight savings. A 6,000 sq. ft. store ships in just one truckload. Easy to assemble.

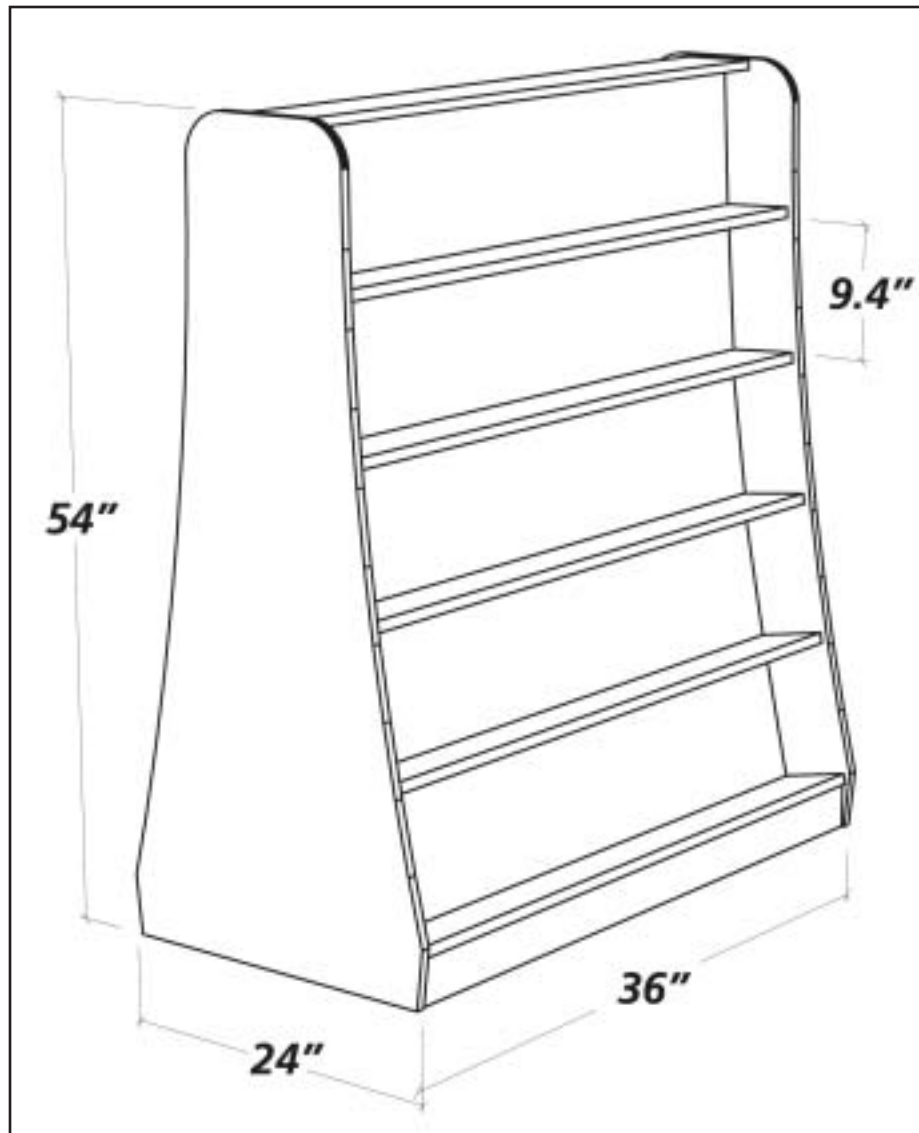

FEATURES

- ◆ 10-Shelf Aisles for maximum center store merchandising.
- ◆ Each shelf is 5" deep for video back-stock or spine-out.
- ◆ Available in white or almond.
- ◆ Add colored end panels, headers, or toe kicks for store branding.
- ◆ Add Slatwall End Panels for merchandising.
- ◆ Fixtures ship knocked-down for freight savings. A 6,000 sq. ft. store ships in just one truckload. Easy to assemble.



FEATURES

- ◆ Effective for display of videos, PPV, candy, or other merchandise at aisle end-caps.
- ◆ Increases rental and/or sale of impulse items.
- ◆ Versatile 3" slatwall for customized location of shelves and accessories.
- ◆ Colored end panels add to store decor and protect end-cap merchandise; slatwall is colored to match fixture shelves.

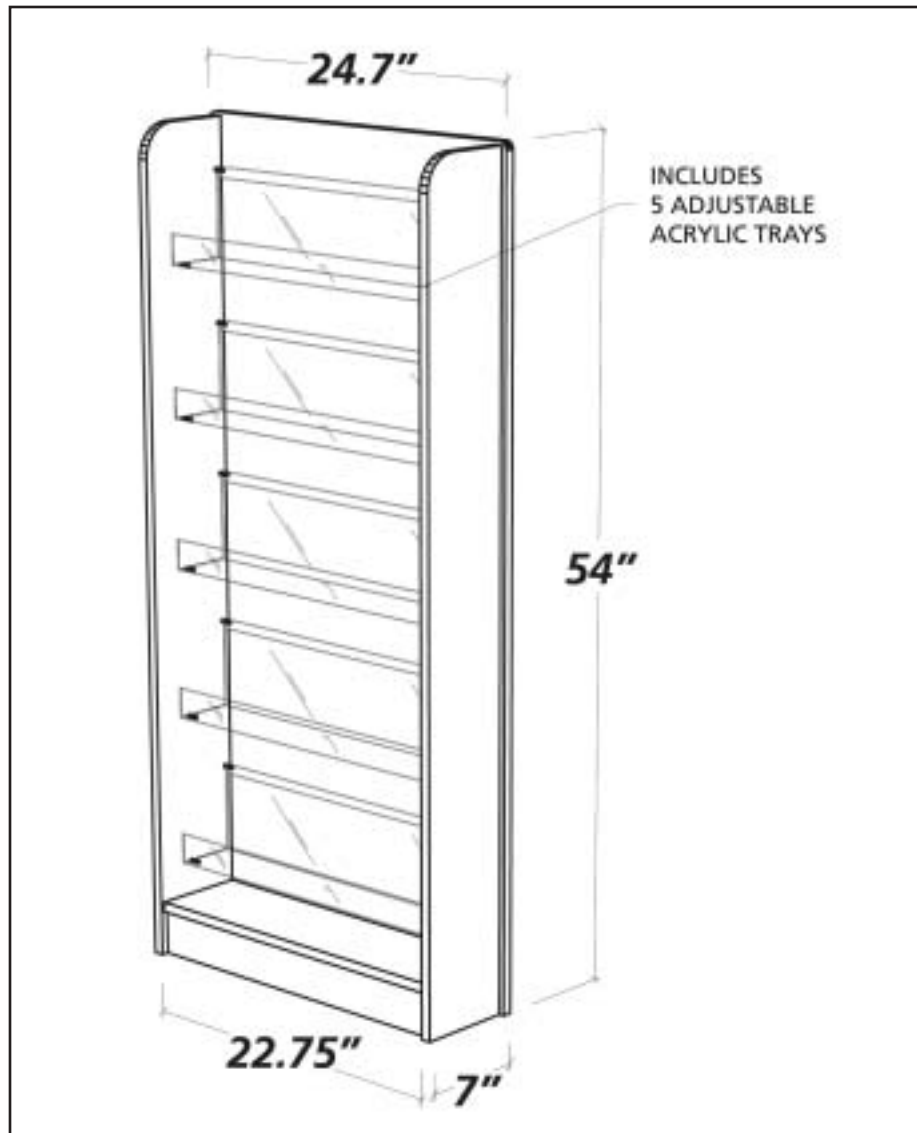

FEATURES

- ◆ Effective for display of videos, PPV, candy, or other merchandise at aisle end-caps.
- ◆ Increases rental and/or sale of impulse items.
- ◆ Versatile 3" slatwall for customized location of shelves and accessories.
- ◆ Colored end panels add to store decor and protect end-cap merchandise; slatwall is colored to match fixture shelves.

Tray Options



23 1/2" Acrylic Tray

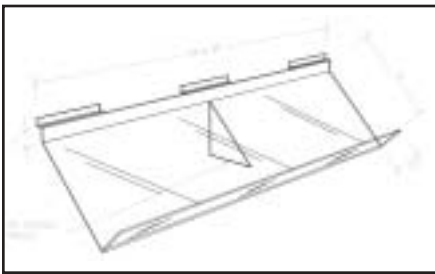

45 Degree Slant Acrylic Tray

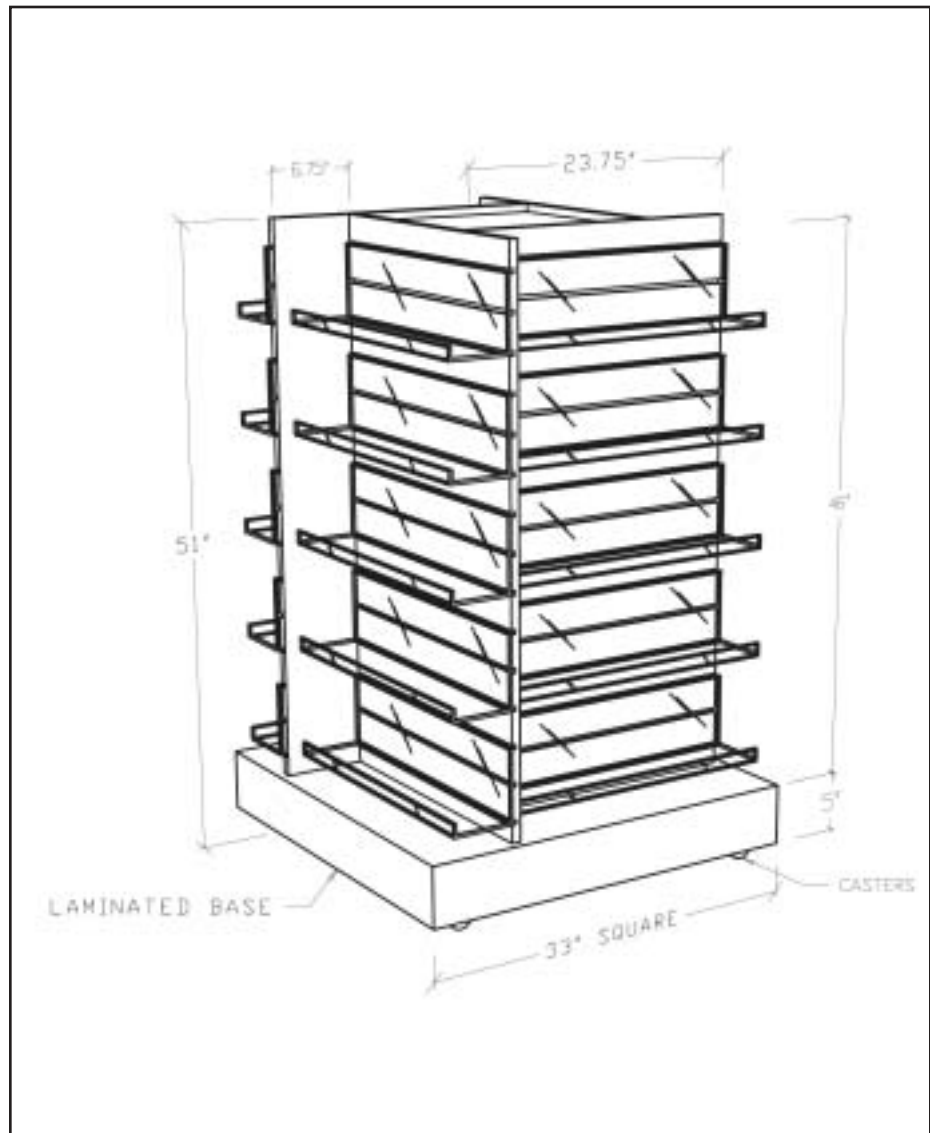

FEATURES

- ◆ 20 Acrylic trays.
- ◆ Casters for easy placement.
- ◆ Promote impulse sales for Previously Viewed Videos.
- ◆ Merchandise Candy, Popcorn and other high-margin items.
- ◆ Slatwall for versatile merchandising.
- ◆ Perfect for center-store placement.

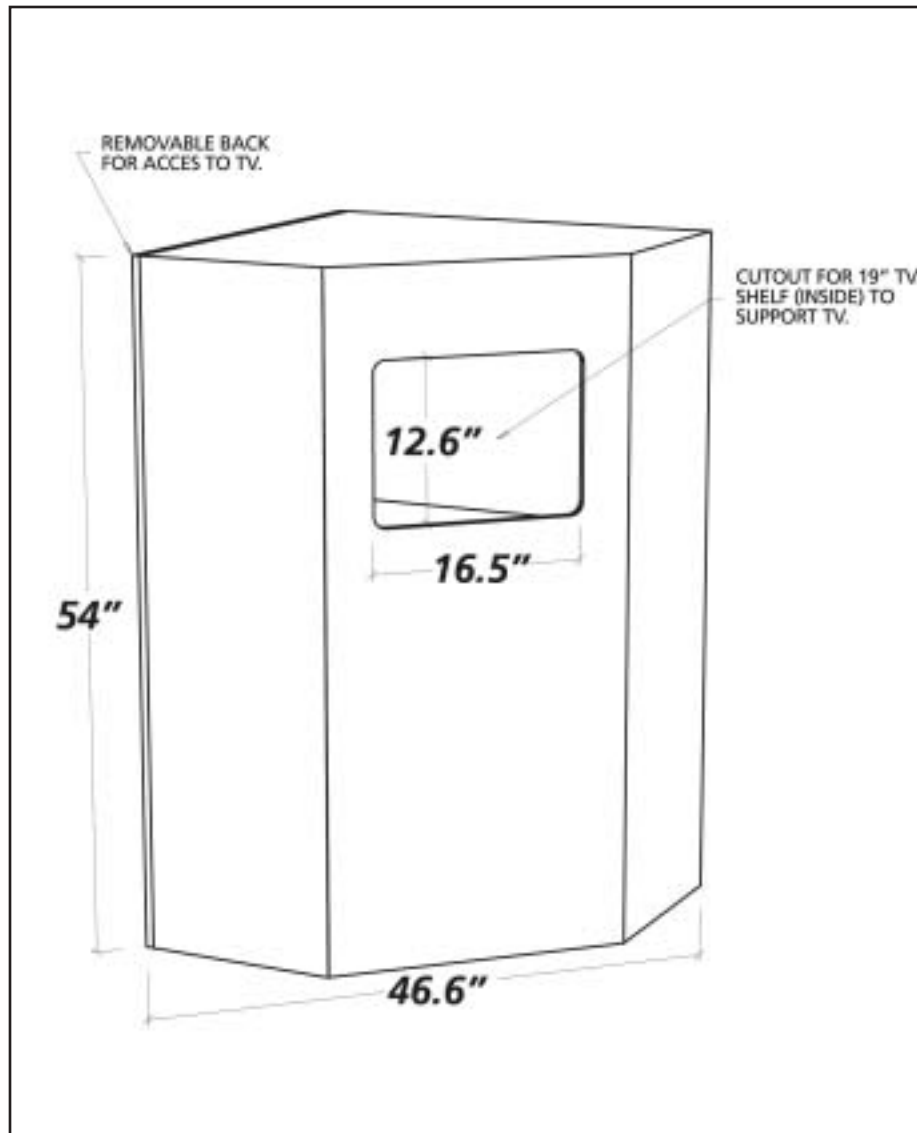

FEATURES

- ◆ Kids Corner TV module
- ◆ Optimized for children
- ◆ Accommodates a 19" TV
- ◆ Removable back panel for TV access



FEATURES

- ◆ Effective to add TV viewing inline with wall shelving for showing movie trailers to promote rentals.
- ◆ Finish panel can be sized to fit up-to 32" TV.
- ◆ Five shelves below TV for display of product.
- ◆ Choose your custom laminate color for TV panel and end panels; shelving in white or almond to match other wall shelving.

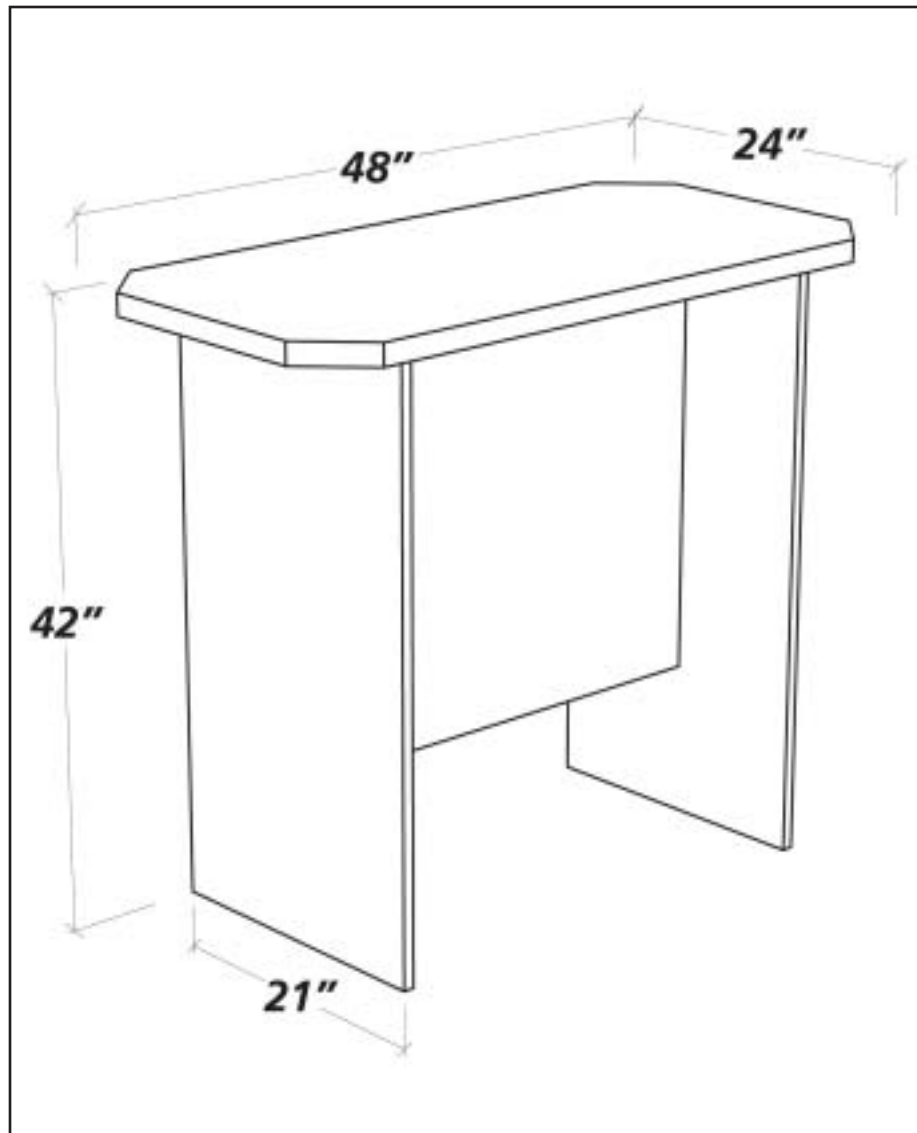

FEATURES

- ◆ New membership application table
- ◆ 41" table top for comfortable standing work height
- ◆ Available in 24" or 48" lengths
- ◆ Clipped corners eliminate sharp ends
- ◆ Island or wall placement

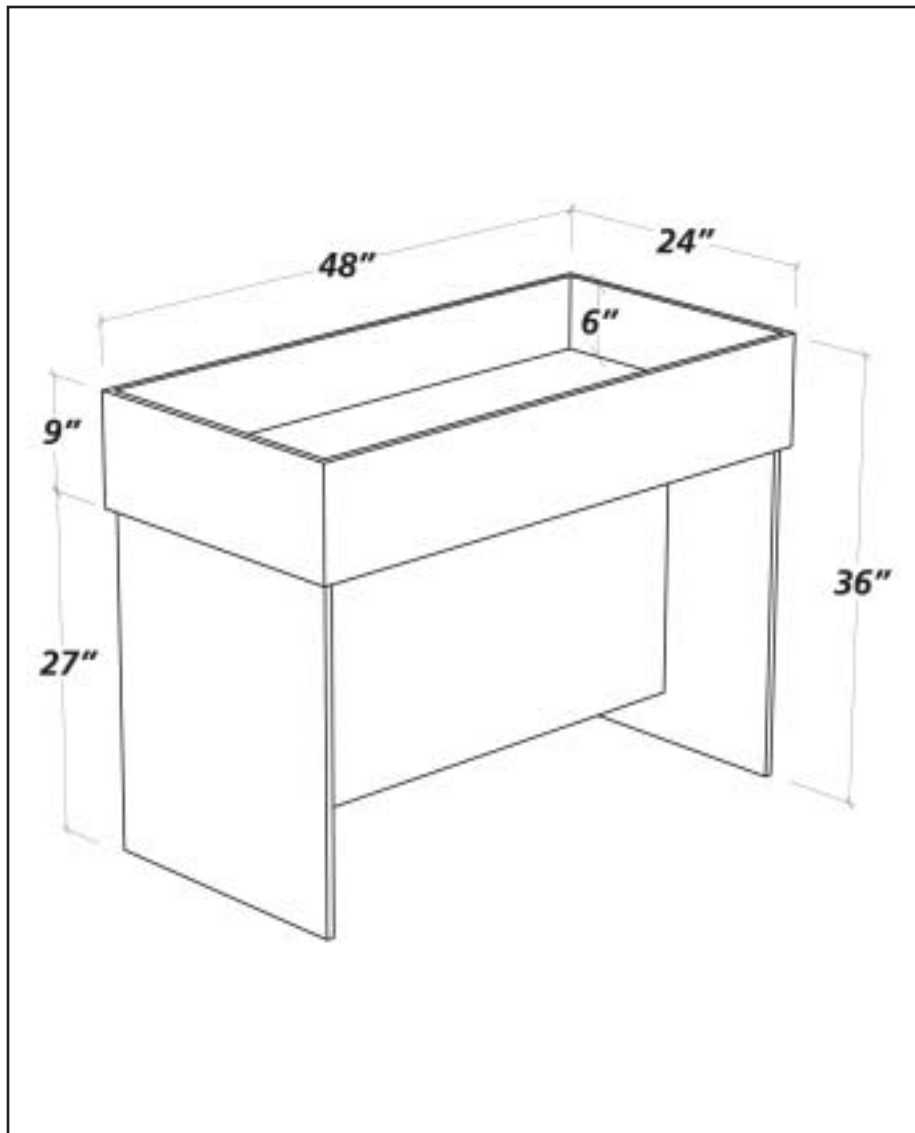

FEATURES

- ◆ Promote impulse sales for Previously Viewed Videos.
- ◆ Merchandise Candy, Popcorn and other high-margin items.
- ◆ Several sizes/styles to promote sales in center-store.
- ◆ Perfect for promotional materials.
- ◆ Perfect for center-store placement.

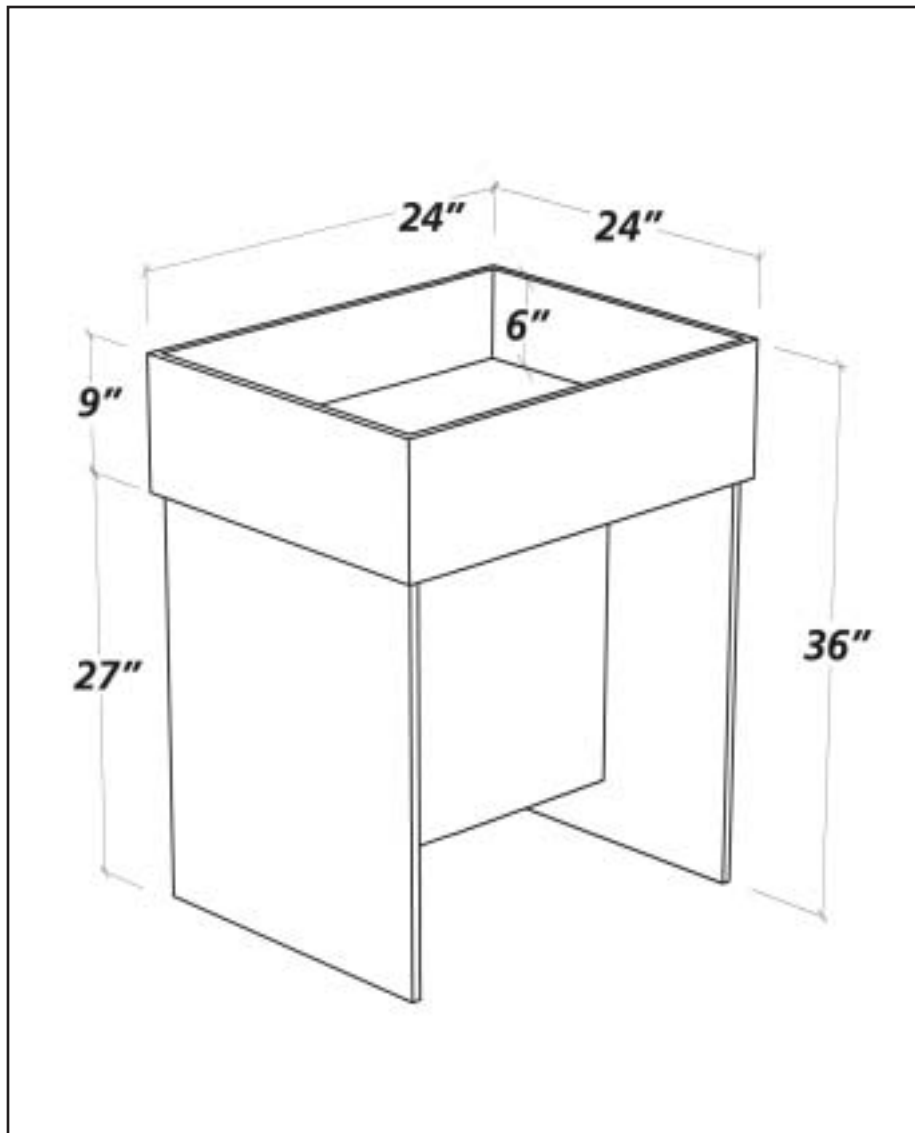

FEATURES

- ◆ Promote impulse sales for Previously Viewed Videos.
- ◆ Merchandise Candy, Popcorn and other high-margin items.
- ◆ Several sizes/styles to promote sales in center-store.
- ◆ Perfect for promotional materials.
- ◆ Perfect for center-store placement.