

DISPLAY CASES

Heated

MILLROCK



FEATURES

- ◆ **Thermostat control** - set the desired temperature up to 165 (degree symbol)
- ◆ **Curved Front Glass** - Sealed Argon insulated double pane front glass
- ◆ **Lights For Every Shelf** - 3 tiers of incandescent fixtures illuminate all products, no shadows & great visibility, Tefl on coated lights included
- ◆ **Humidifier** - Add water for optimal product shelf life with increased humidity
- ◆ **Interior Fan** - Balances heat and humidity distribution
- ◆ **Interior** - Stainless Steel sides
- ◆ **Rear Doors** - Tempered glass, bypass sliding, easy close & lift out for cleaning
- ◆ **Wire Shelves** - (3) tiers of white epoxy coated shelving
- ◆ **Any Exterior Finish** - select any standard color, pattern or wood grain plastic laminate
- ◆ **Bottom Shelf** - Stainless steel for unmatched durability.
- ◆ **Front Toe-kick** - Seamless integration with companion MILLROCK Café Modules
- ◆ **Plug & 8' Cord Included** - 110v. Plug in and start selling!
- ◆ **Meets All Electrical & Sanitation Requirements for USA & Canada** including CSA, ETL, NSF, UL, & CRMA. Certified by CSA & ETL.
- ◆ **Superior Warranty** - 1 year parts and labor

Models

H38

H50

Hot Meals!

Just imagine serving a complete menu. Breakfast: Cinnamon Buns, Ham & Cheese Croissants, Eggs, Home fries, Bacon, Ham, Sausage... Lunch & Dinner: Gourmet Pizza, Pot Pie, chicken dishes with pre-packed sides of squash, mashed potatoes, corn, stuffed baked potato... the options are endless to maximize your real-estate. Your customers will pay a premium for hot meals at Breakfast Lunch & Dinner. Capture incremental sales by serving your existing customers again at Lunch and Dinner. The MILLROCK™ Heated Display Case caters to Home Meal Replacement with complete meals to go! Or, Muffins by Morning! Simply turn off the heat & the MILLROCK Heated Doubles as an Ambient Display Case in the morning for biscotti, bagels, muffins, scones, non-dairy cakes, & croissants.

Tremendous quality, the Millrock Heated features curved glass and four display surfaces maximize capacity and assure exceptional product presentation. Lights on every shelf assure all products are well lit. Finished top surface provides additional valuable display area. The interior walls and floor are Stainless Steel for easy cleaning and unmatched durability. Start maximizing your opportunities for Hot food sales with the premier Heated Display case matching your decor.

MILLROCK Display Cases

Deliver unparalleled merchandising • Match your interior design • Enhance your store image • Boost impulse buying & rapid transactions

Side Panel Options

Full Side



Half Glass



Full Glass

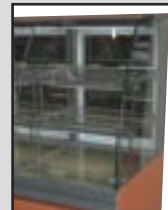

DISPLAY CASES Heated

405 West Street ■ West Bridgewater, MA 02379 ■ p:800.645.7625 ■ f:617.687.7700
e:sales@millrock.com ■ www.millrock.com ■ www.GrowYourBrand.com

© 2000 - 2005 Modular Brand Group, LLC All Rights Reserved. Millrock is a division of Modular Brand Group, LLC
Continual product improvement may necessitate changes in specifications without notice

Rev.082105

DISPLAY CASES

Heated

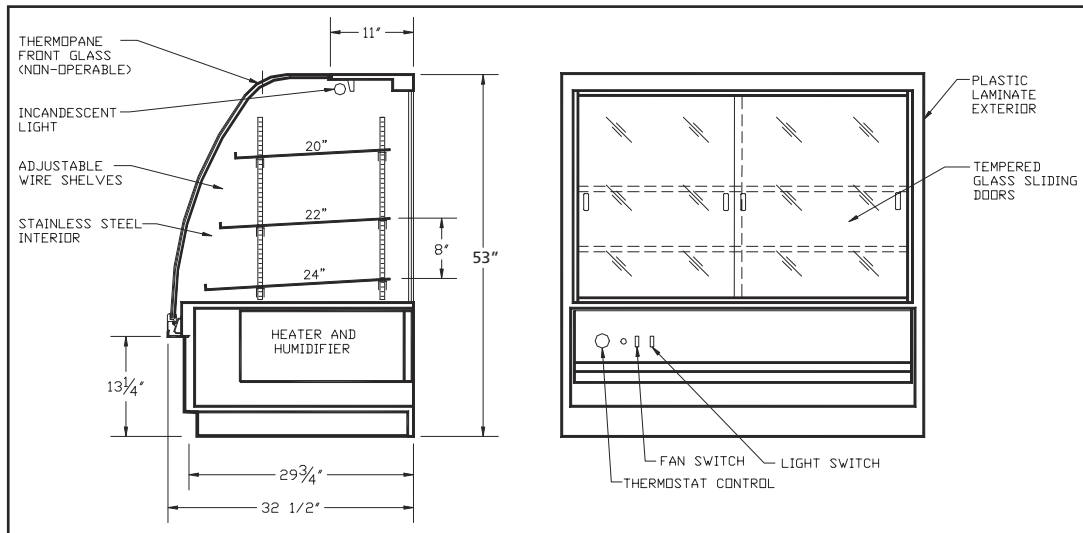

OPTIONS

- ◆ **Custom Finishes** - We welcome the opportunity to match designer finishes with any stone, hardwood, & metal for the front, top or sides of your MILLROCK.
- ◆ **Stone** - Granite top & interior floor
- ◆ **Mirrored Doors** - One way mirrored glass rear doors
- ◆ **Security Kit** - Locking rear doors
- ◆ **Casters** - Easy cleaning, semi-mobile placement, and delivery. Only available at time of order. Add 1/2" to height.
- ◆ **FREE Slim-Sides** - 3/4" thick end panel (reduces overall length by 1 1/2")
- ◆ **Shelving Option** - Stainless Steel or tempered glass shelves
- ◆ **Custom Sizes** - Available in custom depth and height

TECH SPECS

- ◆ **Laboratory Tested** – Every MILLROCK undergoes a 24 hour endurance test with 181 point quality control inspection before shipment
- ◆ **Direct electrical connection** required - no cord and plug.
- ◆ **Maximum temperature** inside case is 165° (74° C)
- ◆ **Humidity** inside case will vary with temperature setting
- ◆ **Meets All Electrical & Sanitation Requirements** for USA & Canada including CSA, ETL, NSF, UL, & CRMA. Certified by ETL.
- ◆ **Warranty** – 1 year parts and labor

MODEL	DIMENSIONS (INCHES) length - depth - height	ELECTRICAL volts/phase/hertz - amps.	SHIPPING WEIGHT / VOLUME lbs. / cu. ft.
H38	38 - 27 - 53	120/240/1/60 - 25	425 / 55.0
H50	50 - 27 - 53	120/240/1/60 - 25	510 / 68.7

405 West Street ■ West Bridgewater, MA 02379 ■ p:800.645.7625 ■ f:617.687.7700
 e:sales@millrock.com ■ www.millrock.com ■ www.GrowYourBrand.com

© 2000 - 2005 Modular Brand Group, LLC All Rights Reserved. Millrock is a division of Modular Brand Group, LLC

Continual product improvement may necessitate changes in specifications without notice

Rev.082105